

1

2

3

4

PLANT SCHEDULE

TREES	QTY	BOTANICAL NAME	COMMON NAME	SIZE
AR	20	ACER RUBRUM 'FLORIDA FLAME'	FLORIDA FLAME RED MAPLE	30 GAL, 11' HT, 3" SPR, 2" CAL
PO	12	PLATANUS OCCIDENTALIS	SYCAMORE	30 GAL, 12' HT, 54" SPR, 2" CAL
OO	9	QUERCUS MICHAUXII	BASKET OAK	30 GAL, 12' HT, 42" SPR, 2" CAL
OV	23	QUERCUS VIRGINIANA	SOUTHERN LIVE OAK	30 GAL, 12' HT, 54" SPR, 2" CAL
TD	30	TAXODIUM DISTICHUM	BALD CYPRESS	30 GAL, 12' HT, 42" SPR, 2" CAL
UA	12	ULMUS ALATA	WINGED ELM	30 GAL, 10' HT, 4" SPR, 2" CAL
GROUND COVERS	QTY	BOTANICAL NAME	COMMON NAME	SIZE
MU	2,448	MULLEBERBERGA CAPILLARIS	PINK WUILY	1 GAL, FULL
SB	397	SPARTINA BAKERI	SAND CORD GRASS	1 GAL, FULL
TG	479	TRIPSAACUM DACTYLOIDES	FAKAWATCHEE GRASS	1 GAL, FULL
SOD/SEED	QTY	BOTANICAL NAME	COMMON NAME	SIZE
SOD		PASPALLUM NOTATUM 'ARGENTINE'	BAHIA GRASS	WEED FREE AND SAND GROWN SOD

LEGEND

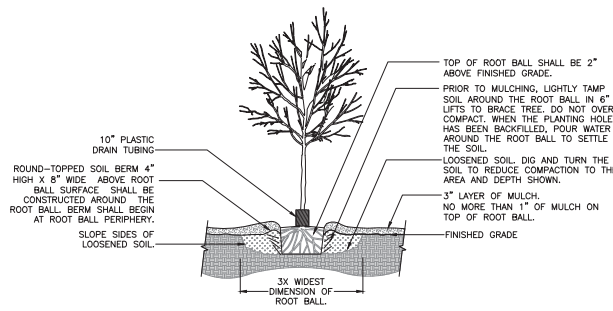
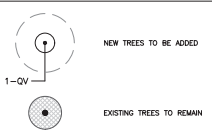

1 TREE PLANTING DETAIL
SCALE: N.T.S.

GENERAL NOTES
ALL ASPHALT, UNBROCK, AND CONSTRUCTION DEBRIS SHALL BE REMOVED FROM PLANTING BEES AND SOD AREAS PRIOR TO LANDSCAPE INSTALLATION. IF ENCOUNTERED DURING CONSTRUCTION OR INSTALLATION, THESE SHALL BE EXCAVATED AND REMOVED FROM THE SITE. PLANTING DEPTH OF SOIL IN SUCH AREAS SHOULD BE AT LEAST 3'. IF FILL MUST BE ADDED, IT MUST BE FLORIDA CLEAN DEEP FILL (FREE OF WEED SEEDS) WITH pH 6.0 - 7.5.

ALL LANDSCAPED AREAS SHALL BE MULCHED WITH 3" THICKNESS OF MULCH. PINE BARK MULCH SHALL BE USED IN ALL AREAS, EXCEPT RETENTION AREAS. PINE STRAW MULCH SHALL BE USED IN RETENTION AREAS.

NEW TREES OUTSIDE OF MULCHED LANDSCAPED BEES WILL BE PROTECTED FROM MOWER AND STRING TRIMMER DAMAGE WITH 10" OF PLASTIC DRAIN TUBING.

LEADER SHOOTS AND MAIN STRUCTURAL LIMBS OF TREES SHALL NOT BE TOPPED OR PRUNED. TREES WILL BE STAKED AS NEEDED. GUYLINES WILL BE OF NON-SYNTHETIC BIODEGRADABLE MATERIAL.

CALL THE URBAN FORESTRY INSPECTOR FOR A BARRICADE INSPECTION AT 352-334-5023 BEFORE CLEANING AND GRUBBING WORK BEGINS. REFER TO CIVIL PLANS FOR TREE BARRICADE DETAILS AND INFORMATION.

INVASIVE EXOTIC PLANT MATERIAL
ALL INVASIVE PLANT SPECIES TO BE REMOVED FROM SITE PRIOR TO ISSUANCE OF THE CERTIFICATE OF OCCUPANCY.

GRASSING
ALL DISTURBED AND UNPAVED AREAS TO BE GRASSED WITH SOD THAT IS FREE OF NOXIOUS WEEDS INCLUDING TROPICAL SODA APPLE OR SHALL BE SEEDED AND MULCHED. SEE CIVIL SITE PLANS FOR ADDITIONAL RELATED INFORMATION.

PLANT MATERIAL
ALL PLANT MATERIAL TO BE FLORIDA NO.1 OR BETTER, GRADED IN ACCORDANCE WITH THE STATE OF FLORIDA DEPARTMENT OF AGRICULTURE, DIVISION OF PLANT INDUSTRY'S 'GRASSES AND STANDARDS FOR NURSERY PLANTS', CURRENT EDITION AT THE TIME PLANS ARE ISSUED. CALL THE CITY URBAN FORESTRY INSPECTOR AT 352-334-5023 AND LANDSCAPE ARCHITECT PRIOR TO PURCHASING ANY PLANT MATERIAL FOR AN ON SITE INSPECTION AND REVIEW OF LANDSCAPE PLAN.

PLANT QUANTITIES SHOWN ARE FOR PERMITTING PURPOSES ONLY. IT IS THE RESPONSIBILITY OF THE CONTRACTOR TO CONFIRM ALL QUANTITIES SHOWN ON THE PLAN.

IRRIGATION
LANDSCAPE IRRIGATION TO BE PROVIDED BY AUTOMATIC IRRIGATION SYSTEM. BUBBLERS SHALL BE INSTALLED BY EACH TREE AS PART OF THE IRRIGATION SYSTEM.

AN AUTOMATIC IRRIGATION SYSTEM IS REQUIRED FOR ALL NEW REQUIRED LANDSCAPING INSTALLED (ALACHUA COUNTY LDC SEC. 407.46(A)). PRIOR TO THE INSTALLATION OF A NEW PERMANENT IRRIGATION SYSTEM, A SUBSTANTIAL MODIFICATION TO AN EXISTING SYSTEM, AN IRRIGATION PLAN MUST BE SUBMITTED TO AND APPROVED BY THE ALACHUA COUNTY ENVIRONMENTAL PROTECTION DEPARTMENT THROUGH THE ONLINE ALACHUA COUNTY IRRIGATION PROFESSIONAL PORTAL. THE CONTRACTOR SHALL BE RESPONSIBLE FOR SUBMITTING THE IRRIGATION PLAN THROUGH THE IRRIGATION PROFESSIONAL PORTAL. THE IRRIGATION SYSTEM SHALL COMPLY WITH THE LANDSCAPE IRRIGATION DESIGN AND MAINTNANCE STANDARDS FOUND IN ARTICLE II OF PART II, TITLE V, CHAPTER 79 OF THE ALACHUA COUNTY CODE, WHICH, AMONG ADDITIONAL DESIGN STANDARDS, LISTS HIGH VOLUME IRRIGATION TO 60X OF THE LANDSCAPED AREA. FOR MORE INFORMATION, CONTACT THE ALACHUA COUNTY ENVIRONMENTAL PROTECTION DEPARTMENT AT 352-344-8600.

T.M.P.A.
SITE IS LOCATED IN ZONE A OF THE TRANSPORTATION MOBILITY PROGRAM AREA.

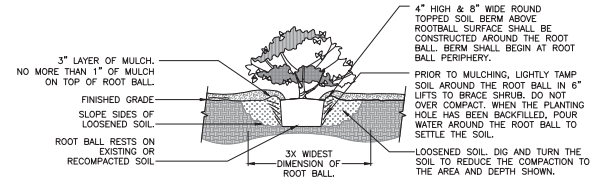

2 SHRUB PLANTING DETAIL
SCALE: N.T.S.

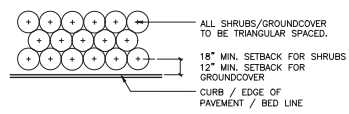

3 MULCH DETAIL
SCALE: N.T.S.

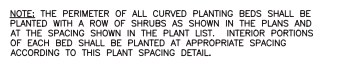

4 SHRUB PLANTING DETAIL
SCALE: N.T.S.

NOTE: THE PERIMETER OF ALL CURVED PLANTING BEDS SHALL BE PLANTED WITH A ROW OF SHRUBS AS SHOWN IN THE PLANS AND AT THE SPACING SHOWN IN THE PLANT LIST. INTERIOR PORTIONS OF EACH BED SHALL BE PLANTED AT APPROPRIATE SPACING ACCORDING TO THIS PLANT SPACING DETAIL.

TREE MITIGATION CALCULATIONS Sec. 30-254(c)(4)

CATEGORY	MITIGATION CALCULATIONS
TREE APPRAISED VALUE (T.A.V.)	TOTAL TREES IN CATEGORY TO BE MITIGATED.....15 TREES
	MAXIMUM APPRAISED TREES.....31 TREES
	MAXIMUM 3 TREES PER ACRE
	TOTAL PROJECT SITE AREA: 10.03 ACRES
	TREES BEYOND MAXIMUM, TO BE MITIGATED AT INCH FOR INCH REPLACEMENT (SEE BELOW).....0 TREES
	APPRAISED TREES:
	21" LO \$7,616.07
	22"28" LO \$21,898.36
	23" LO \$8,155.83
	25" LO \$10,793.75
	26" LO \$11,674.52
	27" LO \$12,589.83
	28" LO \$13,539.68
	28" LO \$13,539.68
	29" LO \$14,524.07
	29" LO \$14,524.07
	30" LO \$24,937.88
	40" LO \$27,632.00
	41" LO \$29,030.87
	50" LO \$52,241.75
	+ 24" SWAMP CHEE = \$9,847.02
	TOTAL = \$273,625.88

INCH-FOR-INCH REPLACEMENT	T.A.V. TREES BEYOND MAXIMUM
0" SPECIES.....	0"
	HIGH-QUALITY HERITAGE TREES IN LESS THAN FAIR CONDITION.....
0" SPECIES.....	0"
	NON-HIGH QUALITY HERITAGE TREES IN FAIR OR BETTER CONDITION
	21" MAPLE.....21"
	23" MAPLE.....23"
	20" COTTONWOOD.....20"
	20" COTTONWOOD.....20"
	23" COTTONWOOD.....23"
	23" COTTONWOOD.....23"
	24" COTTONWOOD.....24"
	25" COTTONWOOD.....25"
	25" COTTONWOOD.....25"
	25" COTTONWOOD.....25"
	27" COTTONWOOD.....27"
	28" COTTONWOOD.....28"
	29" COTTONWOOD.....29"
	29"39" COTTONWOOD.....68"
	31" COTTONWOOD.....31"
	33" COTTONWOOD.....33"
	36" COTTONWOOD.....36"
	42" COTTONWOOD.....42"
	21" BOX ELDER.....21"
	21" BOX ELDER.....21"
	24" BOX ELDER.....24"
	26" BOX ELDER.....26"
	37" BOX ELDER.....37"
	TOTAL INCHES REQUIRED.....692"

21" REPLACEMENT	TOTAL TREES TO BE MITIGATED AT 21" REPLACEMENT.....405 TREES
	TOTAL TREES REQUIRED FOR MITIGATION @ 21" REPLACEMENT.....810 TREES
	TOTAL INCHES REQUIRED @ 2"/TREE.....1,620"

TOTAL TREE MITIGATION	TOTAL MITIGATION INCHES REQUIRED.....2,272"
	TOTAL MITIGATION PROVIDED.....212"
	106 TREES @ 2"/TREE FOR A TOTAL OF 212"
	TOTAL MITIGATION INCHES DEFICIT.....2,060"
	TOTAL MITIGATION TREES REQUIRED @ 2"/TREE.....1,030 TREES

TOTAL MITIGATION PAYMENT	TOTAL MITIGATION PAYMENT:
	TREE APPRAISALS TOTAL.....\$273,625.88
	DEFICIT PAYMENT (\$102/TREE).....\$103,000.00
	TOTAL PAYMENT REQUIRED.....\$376,625.88

* TOTAL MITIGATION PAYMENT SHALL BE MADE PRIOR TO THE ISSUANCE OF THE SITE WORK PERMIT.

811 KNOW WHAT'S BELOW ALWAYS CALL 811 BEFORE YOU DIG. It's fast, it's free, it's the law. Call 811 two business days before digging.

CHW CONSULTANTS AND DESIGNERS
 PROJECT NO. 2023-1068D
 SHEET NO. 1
 DATE: 11/09/23
 PROJECT: URBAN FORESTRY IRRIGATION AND LANDSCAPE DETAILS
 LOCATION: 1100 S. UNIVERSITY BLVD., SUITE 100, GAINESVILLE, FL 32609
 CLIENT: CITY OF GAINESVILLE, FLORIDA
 PROJECT: URBAN FORESTRY IRRIGATION AND LANDSCAPE DETAILS
 SHEET NO. 1 OF 1
 DATE: 11/09/23

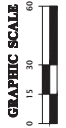
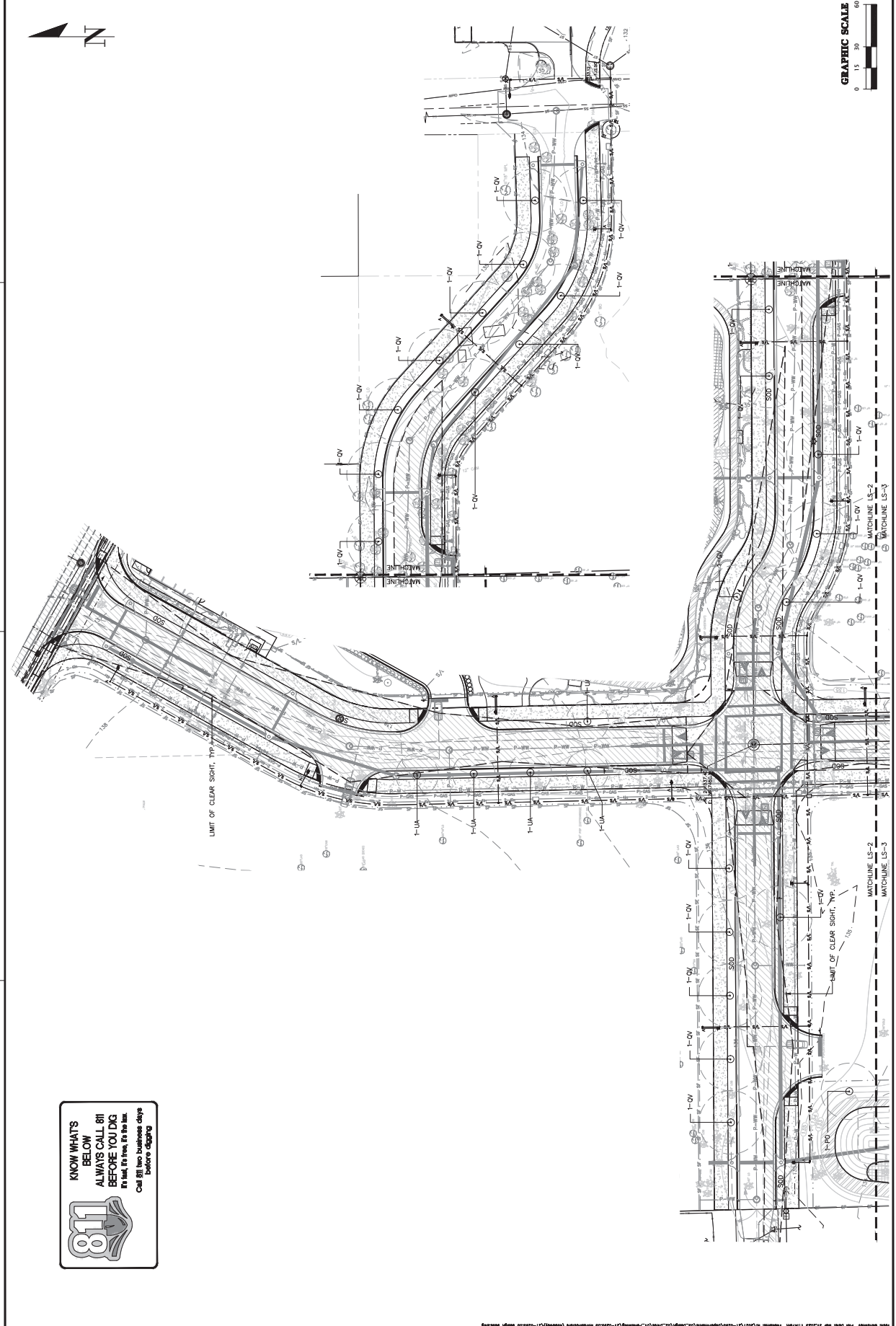

KNOW WHAT'S BELOW
ALWAYS CALL 811 BEFORE YOU DIG
 It's fast, it's free, it's the law.
 Call 811 two business days before digging.



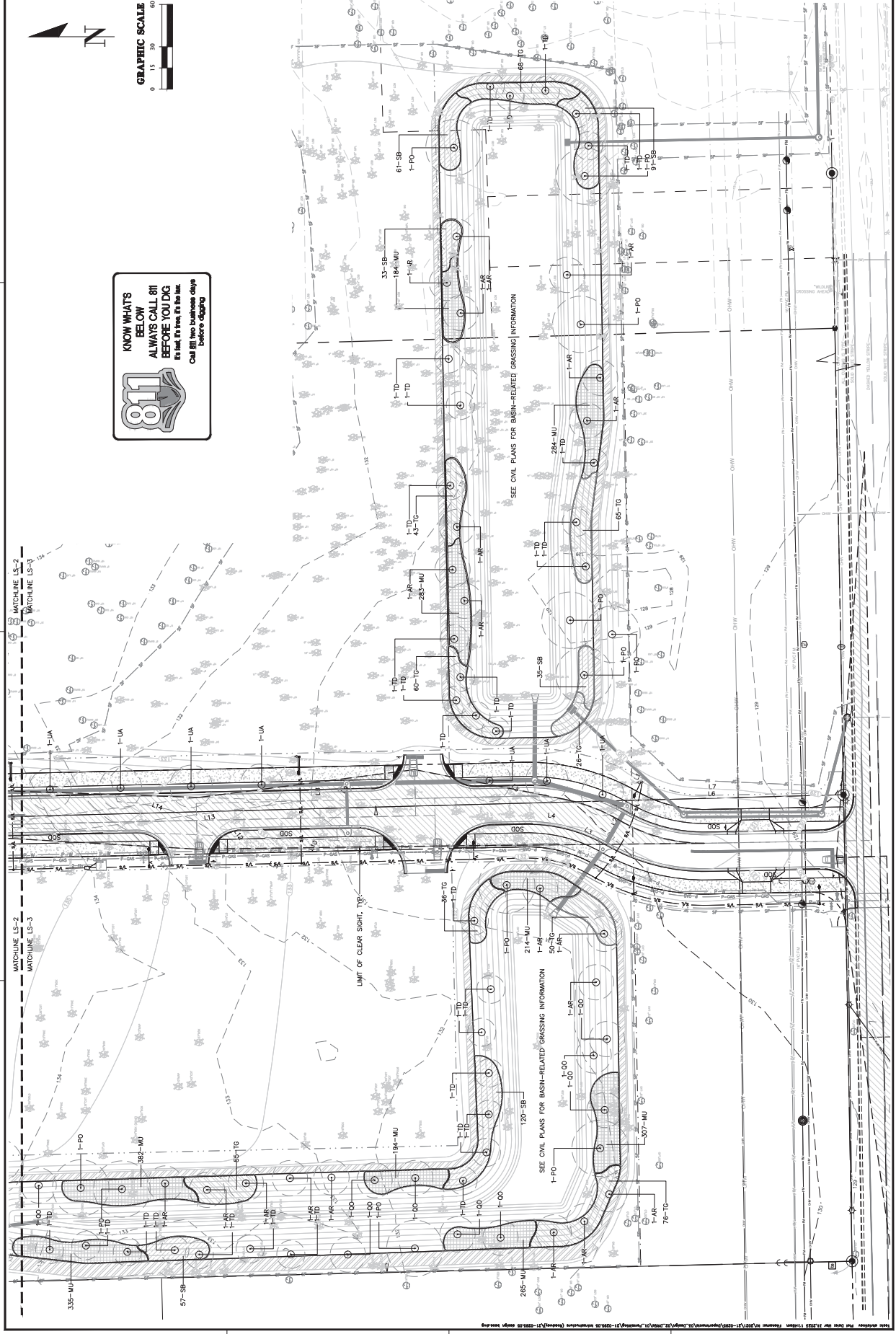



KNOW WHAT'S BELOW
BEFORE YOU DIG
ALWAYS CALL 811
BEFORE YOU DIG
 Call 811 two business days before digging