

Exhibit A to Ordinance No. 211460
10 pages



April 8, 2017

Legal Description

Weyerhaeuser Company PD East of State Road No. 121

A portion of Fractional Sections 6, lying inside and outside of the Arredondo Grant, and a portion of Section 7, Township 9 South, Range 20 East, and a portion of Section 31, Township 8 South, Range 20 East, Alachua County, Florida; being more particularly described as follows:

Commence at an unidentified 4" square concrete monument at the southeast corner of the North Half (N 1/2) of Government Lot 8 of Section 31, Township 8 South, Range 20 East, Alachua County, Florida and run thence South 86°10'18" West, along the South line of said North Half (N 1/2) a distance of 531.72 feet to the Point of Beginning; thence continue South 86°10'18" West, along said South line and along the South line of the North Half (N 1/2) of Government Lot 7, a distance of 2034.07 feet to a 4" square concrete monument and cap (stamped "C&E INC LB5075") and to a point on the East Right of Way line of Sate Road No. 121 (120 foot wide Right of Way); thence South 10°43'21" East, along said East Right of Way line, 1261.90 feet to the beginning of a curve, concave westerly, having a radius of 5789.58 feet; thence southerly, along said East Right of Way line and along the arc of said curve, through a central angle of 03°22'05", an arc distance of 340.33 feet, said arc being subtended by a chord, having a bearing and distance of South 09°02'18" East, 340.28 feet; thence South 10°43'20" East, along said East Right of Way line, 20.58 feet to the beginning of a curve, concave westerly, having a radius of 1959.86 feet; thence southerly, along said East Right of Way line and along the arc of said curve, through a central angle of 10°47'22", an arc distance of 369.06 feet to the end of said curve, said arc being subtended by a chord, having a bearing and distance of South 05°19'39" East, 368.52 feet; thence South 00°04'02" West, along said East Right of Way line, 20.58 feet to a point lying on the arc of a curve, concave westerly, having a radius of 5789.58 feet; thence southerly, along said East Right of Way line, and along the arc of said curve, through a central angle of 03°22'05", an arc distance of 340.33 feet, said arc being subtended by a chord, having a bearing and distance of South 01°37'01" East, 340.28 feet; thence South 00°03'52" West, along said East Right of Way line, 4311.44 feet to a 4" square concrete monument and cap stamped "PRM LS2742" at the northwest corner of Buck Bay Replat, a subdivision as per plat thereof, recorded in Plat Book "M", page 17 of the Public Records of Alachua County, Florida; thence North 88°57'10" East, along the North boundary of said Buck Bay Replat, 836.16 feet; thence North 08°12'22" East, 55.96 feet; thence North 08°12'22" East, 66.31 feet; thence North 09°52'10" East, 69.26 feet; thence North 47°21'19" East, 75.56 feet; thence North 35°55'15" East, 98.74 feet; thence North 37°08'33" West, 84.76 feet; thence North 71°57'16" West, 46.34 feet; thence South 80°13'08" West, 83.17 feet; thence North 64°43'13" West, 77.30 feet;

thence North 32°59'37" West, 59.65 feet; thence North 32°59'37" West, 27.45 feet;
thence North 27°39'55" West, 59.60 feet; thence North 21°24'52" East, 109.19 feet;
thence North 54°03'15" East, 55.12 feet; thence South 85°27'01" East, 87.74 feet;
thence North 68°36'41" East, 59.15 feet; thence North 08°49'31" East, 183.22 feet;
thence North 00°30'49" East, 193.83 feet; thence North 89°56'43" West, 612.29 feet;
thence North 00°03'46" East, 688.05 feet; thence South 89°56'08" East, 466.58 feet;
thence North 12°51'09" East, 213.34 feet; thence North 38°47'18" East, 119.99 feet;
thence North 00°48'36" East, 374.75 feet; thence North 17°07'12" East, 83.75 feet;
thence North 68°32'20" East, 63.52 feet; thence North 67°28'17" East, 147.21 feet;
thence North 01°30'38" West, 93.83 feet; thence North 03°58'22" West, 93.54 feet;
thence North 57°42'46" West, 115.05 feet; thence North 29°02'34" West, 97.53 feet;
thence North 01°46'17" East, 168.60 feet; thence North 20°37'40" East, 140.97 feet;
thence North 04°57'35" East, 109.96 feet; thence North 12°49'04" East, 132.48 feet;
thence North 18°54'40" West, 143.15 feet; thence North 10°16'48" East, 94.27 feet;
thence North 06°02'22" East, 101.92 feet; thence North 45°54'46" East, 126.64 feet;
thence North 16°46'10" West, 115.18 feet; thence North 12°02'02" West, 86.71 feet;
thence North 44°42'24" East, 85.42 feet; thence North 85°34'46" East, 99.34 feet;
thence North 07°34'04" West, 145.72 feet; thence North 48°09'42" West, 84.81 feet;
thence South 85°00'49" West, 120.15 feet; thence South 81°05'28" West, 74.12 feet;
thence South 58°25'58" West, 85.49 feet; thence South 77°31'16" West, 80.60 feet;
thence South 77°47'23" West, 91.07 feet; thence South 68°52'37" West, 115.44 feet;
thence North 81°35'22" West, 97.08 feet; thence North 77°30'19" West, 119.84 feet;
thence North 84°24'03" West, 90.02 feet; thence North 57°01'47" West, 74.62 feet;
thence North 53°14'15" West, 75.94 feet; thence North 18°26'05" West, 93.38 feet;
thence North 00°05'04" East, 112.14 feet; thence North 33°52'06" West, 45.99 feet;
thence North 17°03'32" West, 95.71 feet; thence North 28°02'23" West, 71.54 feet;
thence North 17°36'52" East, 187.82 feet; thence North 17°36'52" East, 65.79 feet;
thence North 79°16'39" East, 423.02 feet; thence South 18°26'40" East, 159.51 feet;
thence North 70°56'37" East, 67.50 feet; thence North 67°27'33" East, 101.79 feet;
thence North 38°29'13" East, 91.85 feet; thence North 03°08'02" East, 94.53 feet;
thence North 03°47'10" East, 107.35 feet; thence North 11°30'52" West, 97.01 feet;
thence North 59°39'32" East, 92.92 feet; thence North 28°09'59" West, 109.03 feet;
thence North 15°35'54" West, 57.89 feet; thence North 06°30'09" West, 61.24 feet;
thence North 06°30'09" West, 33.48 feet; thence North 50°06'16" East, 71.96 feet;
thence North 24°40'49" West, 22.52 feet; thence North 24°40'49" West, 97.40 feet;
thence North 10°48'55" West, 64.87 feet; thence North 17°53'11" East, 86.49 feet;
thence North 35°39'46" East, 84.42 feet; thence North 27°00'23" East, 95.75 feet;
thence North 11°01'21" East, 112.79 feet; thence North 09°52'11" East, 96.82 feet;
thence North 18°47'52" East, 95.58 feet; thence North 34°11'44" East, 105.45 feet;
thence South 63°14'27" East, 54.90 feet; thence South 67°24'01" East, 100.38 feet;
thence North 63°39'57" East, 74.44 feet; thence South 89°44'34" East, 103.07 feet;
thence North 26°33'45" East, 109.81 feet; thence North 58°40'20" East, 105.85 feet;
thence North 43°38'52" East, 61.09 feet; thence North 77°33'32" East, 99.95 feet;
thence North 22°59'34" East, 112.80 feet to the Point of Beginning.

Containing 130.391 Acres (5,679,827 Square Feet), more or less.

J:\Bob\Plum Creek\PlumCreekSR121East.docx



April 8, 2017

Legal Description

Weyerhaeuser PD West of State Road No. 121

A portion of Fractional Sections 1, lying inside and outside of the Arredondo Grant, and a portion of Section 12, Township 9 South, Range 19 East, and a portion of Fractional Sections 6, lying inside and outside of the Arredondo Grant, and a portion of Section 7, Township 9 South, Range 20 East, and a portion of Section 36, Township 8 South, Range 19 East, and a portion of Section 31, Township 8 South, Range 20 East, Alachua County, Florida; being more particularly described as follows:

Begin at a 4" square unidentified concrete monument at the southwest corner of Fractional Section 1, Township 9 South, Range 19 East, inside the Arredondo Grant, Alachua County, Florida and run thence North $00^{\circ}55'38''$ West, along the West boundary of said Fractional Section 1, a distance of 2460.62 feet to a point lying 25.00 feet southerly of the North boundary of said Fractional Section 1 (measured perpendicular); thence North $89^{\circ}01'39''$ East, parallel with and 25.00 feet southerly of said North boundary of Fractional Section 1 and the North boundary of the Arredondo Grant, 1446.85 feet; thence South $14^{\circ}09'27''$ West, 105.34 feet; thence South $41^{\circ}33'14''$ West, 92.41 feet; thence South $33^{\circ}16'27''$ West, 103.63 feet; thence South $25^{\circ}21'21''$ West, 99.27 feet; thence South $14^{\circ}04'55''$ West, 7.34 feet; thence South $36^{\circ}52'45''$ West, 157.02 feet; thence South $15^{\circ}06'42''$ West, 162.22 feet; thence South $35^{\circ}15'14''$ West, 140.20 feet; thence South $12^{\circ}58'02''$ West, 157.26 feet; thence South $83^{\circ}50'05''$ East, 118.75 feet; thence South $88^{\circ}57'36''$ East, 114.33 feet; thence North $21^{\circ}28'59''$ East, 76.40 feet; thence North $73^{\circ}58'41''$ East, 161.26 feet; thence South $73^{\circ}45'56''$ East, 82.68 feet; thence South $77^{\circ}37'02''$ East, 71.45 feet; thence South $40^{\circ}26'52''$ East, 65.08 feet; thence North $19^{\circ}44'26''$ East, 94.75 feet; thence South $39^{\circ}08'13''$ East, 127.75 feet; thence North $84^{\circ}56'13''$ East, 84.09 feet; thence North $20^{\circ}36'06''$ East, 85.47 feet; thence North $43^{\circ}41'57''$ West, 91.81 feet; thence North $07^{\circ}36'51''$ West, 74.34 feet; thence North $30^{\circ}08'35''$ East, 59.64 feet; thence North $64^{\circ}16'39''$ East, 83.92 feet; thence South $79^{\circ}01'55''$ East, 135.83 feet; thence South $85^{\circ}00'01''$ East, 90.90 feet; thence South $81^{\circ}42'25''$ East, 83.01 feet; thence South $69^{\circ}23'10''$ East, 114.80 feet; thence South $38^{\circ}55'17''$ East, 66.80 feet; thence South $68^{\circ}11'29''$ East, 127.52 feet; thence North $66^{\circ}53'18''$ East, 174.50 feet; thence South $52^{\circ}54'00''$ East, 53.95 feet; thence South $45^{\circ}13'13''$ East, 64.39 feet; thence South $14^{\circ}45'40''$ East, 72.79 feet; thence South $49^{\circ}55'59''$ East, 84.90 feet; thence South $81^{\circ}16'43''$ East, 85.33 feet; thence North $63^{\circ}23'54''$ East, 90.94 feet; thence North $24^{\circ}24'22''$ East, 96.79 feet; thence North $02^{\circ}23'26''$ East, 73.27 feet; thence North $01^{\circ}19'34''$ East, 169.62 feet; thence North $59^{\circ}51'56''$ East, 100.44 feet; thence North $49^{\circ}09'57''$ East, 92.90 feet; thence North $36^{\circ}33'16''$ East, 100.26 feet; thence North $11^{\circ}41'28''$ West, 87.67 feet; thence North $14^{\circ}03'33''$ East, 158.15 feet; thence North $14^{\circ}34'41''$ East, 21.31 feet;

thence North 69°35'01" West, 106.24 feet; thence North 29°08'47" West, 128.14 feet; thence North 16°17'42" West, 93.10 feet; thence North 20°22'26" West, 70.08 feet; thence North 36°13'00" East, 75.56 feet; thence North 20°44'12" East, 89.07 feet; thence North 50°54'02" East, 81.13 feet; thence North 75°07'05" West, 156.71 feet; thence South 34°09'02" East, 122.80 feet; thence South 31°29'31" West, 66.09 feet; thence North 55°49'02" West, 108.05 feet; thence South 52°29'11" West, 135.78 feet; thence South 85°12'54" West, 140.53 feet; thence North 64°11'49" West, 102.14 feet; thence North 09°02'00" West, 64.82 feet; thence South 52°19'21" West, 52.19 feet; thence North 06°41'08" West, 122.50 feet to a point lying 25.00 feet easterly of (measured perpendicular) the easterly line of a 50' wide Florida Gas Transmission Easement, as described in Official Records Book 48, page 205 of the Public Records of Alachua County, Florida, and 25.00 feet easterly of (measured perpendicular) the easterly line of the City of Gainesville Property as described in Official Records Book 2579, page 5 of said Public Records; thence North 03°23'37" East, parallel with and 25.00 feet easterly of said easterly lines, 256.43 feet; thence South 13°13'51" East, 34.07 feet; thence South 26°58'15" East, 54.31 feet; thence North 80°35'23" East, 31.87 feet; thence South 86°00'49" East, 53.28 feet; thence North 74°20'09" East, 96.89 feet; thence North 72°34'34" East, 41.50 feet; thence North 70°23'42" East, 59.30 feet; thence North 11°20'07" East, 67.01 feet; thence North 08°51'44" East, 49.82 feet; thence North 36°38'31" West, 113.41 feet; thence North 20°32'54" East, 39.04 feet; thence North 28°45'25" East, 61.07 feet; thence North 05°55'05" East, 65.51 feet; thence North 32°15'24" East, 95.73 feet; thence North 38°23'34" East, 66.11 feet; thence North 35°40'51" East, 141.63 feet; thence South 33°54'03" East, 42.61 feet; thence South 33°54'03" East, 33.86 feet; thence South 37°31'34" West, 87.64 feet; thence South 17°59'04" West, 175.53 feet; thence South 00°18'59" East, 215.73 feet; thence South 29°26'57" East, 164.90 feet; thence South 84°46'26" East, 103.72 feet; thence South 79°10'53" East, 119.14 feet; thence North 44°33'15" East, 56.92 feet; thence North 49°58'06" East, 142.19 feet; thence North 45°43'22" East, 218.65 feet; thence North 14°31'52" West, 195.87 feet; thence North 44°44'46" West, 206.03 feet; thence North 89°10'42" West, 157.68 feet; thence North 83°29'49" West, 136.22 feet; thence North 32°51'25" West, 35.78 feet; thence North 32°51'25" West, 45.08 feet; thence North 18°58'55" East, 22.43 feet; thence North 18°58'55" East, 105.95 feet; thence North 17°33'21" East, 79.87 feet; thence North 44°30'18" East, 77.59 feet; thence North 21°52'21" East, 134.18 feet; thence South 15°58'25" East, 0.72 feet; thence North 22°03'47" East, 5.84 feet; thence South 62°16'09" East, 64.46 feet; thence South 68°20'40" East, 80.46 feet; thence North 84°49'09" East, 77.77 feet; thence North 27°53'51" East, 74.54 feet; thence North 21°15'59" East, 333.13 feet; thence North 78°25'18" West, 95.06 feet; thence South 89°09'07" West, 81.43 feet; thence South 70°10'12" West, 56.93 feet; thence South 66°36'41" West, 221.09 feet; thence South 13°48'19" West, 134.71 feet; thence South 50°08'18" East, 91.58 feet; thence South 27°29'53" West, 176.79 feet; thence South 05°24'58" East, 50.06 feet; thence South 30°54'31" West, 50.30 feet; thence South 18°20'00" West, 56.78 feet; thence South 20°41'16" West, 81.37 feet; thence South 20°04'21" West, 51.29 feet; thence South 32°34'23" West, 59.53 feet; thence South 36°39'33" West, 78.69 feet; thence South 43°22'43" West, 81.19 feet; thence South 38°00'27" West, 83.68 feet; thence South 04°25'05" West, 77.87 feet; thence South 25°55'58" West, 55.16 feet; thence South

89°05'01" West, 56.73 feet; thence North 65°02'33" West, 71.53 feet; thence South 66°34'17" West, 98.36 feet; thence South 39°19'57" West, 53.71 feet to a point lying 25.00 feet easterly of (measured perpendicular) said easterly lines of a 50' wide Florida Gas Transmission Easement and the City of Gainesville Property; thence North 03°23'37" East, parallel with and 25.00 feet easterly of said easterly lines, 994.81 feet to a point hereinafter referred to as Point "A"; thence North 81°43'14" East, 76.58 feet; thence South 68°09'08" East, 103.70 feet; thence South 58°43'02" East, 66.52 feet; thence South 11°09'41" West, 57.89 feet; thence South 17°04'46" East, 43.45 feet; thence South 34°02'21" East, 73.99 feet; thence North 80°33'19" East, 111.57 feet; thence North 06°09'50" West, 165.29 feet; thence North 08°12'08" West, 81.76 feet; thence North 86°10'38" West, 75.98 feet; thence North 05°40'57" West, 101.05 feet; thence North 66°11'24" West, 105.36 feet; thence North 60°00'23" West, 93.65 feet; thence North 67°55'23" West, 20.67 feet; thence North 88°24'09" West, 9.86 feet; thence South 01°12'26" West, 63.76 feet; thence South 07°34'07" West, 86.98 feet; thence South 03°24'34" West, 61.25 feet; thence South 52°20'40" West, 55.23 feet to said Point "A"; thence North 03°23'37" East, parallel with and 25.00 feet easterly of said easterly lines, 1242.44 feet; thence South 64°11'43" East, 183.31 feet; thence South 72°57'34" East, 192.99 feet; thence South 89°26'39" East, 146.10 feet; thence South 10°40'36" East, 102.38 feet; thence South 05°37'06" East, 204.29 feet; thence South 15°45'53" West, 150.08 feet; thence South 43°27'34" West, 52.04 feet; thence North 57°04'11" West, 94.94 feet; thence South 62°22'59" West, 138.35 feet; thence South 75°13'43" West, 87.54 feet; thence South 19°23'55" West, 147.90 feet; thence South 59°47'05" East, 116.24 feet; thence South 56°16'51" East, 158.06 feet; thence South 47°49'21" East, 199.56 feet; thence South 69°37'30" East, 71.60 feet; thence North 04°33'09" East, 135.94 feet; thence North 43°31'42" East, 160.89 feet; thence North 21°46'56" East, 93.14 feet; thence South 62°16'32" East, 107.19 feet; thence North 29°49'15" East, 172.56 feet; thence North 29°49'15" East, 20.27 feet; thence North 13°57'47" East, 81.34 feet; thence North 13°57'47" East, 81.34 feet; thence North 03°27'54" East, 79.71 feet; thence North 68°06'50" East, 192.87 feet; thence North 40°13'02" East, 159.49 feet; thence North 30°19'12" East, 89.98 feet; thence South 89°13'53" East, 79.79 feet; thence North 70°16'43" East, 140.16 feet; thence North 70°16'43" East, 30.81 feet; thence North 43°00'08" East, 48.25 feet; thence North 76°23'55" East, 362.83 feet to a 4" square concrete monument and cap stamped "C&E INC. LB5075" at the southwest corner of the Gaston property as described in Official Records Book 3578, page 1012 of said Public Records; thence North 79°16'39" East, 660.00 feet to a 4" square concrete monument and cap stamped "C&E Inc. LB5075" at the southeast corner of said Gaston property and to a point lying on the westerly Right of Way line of State Road No. 121 (120 foot wide Right of Way); thence South 10°43'21" East, along said westerly Right of Way line, 2409.72 feet to the beginning of a curve, concave westerly, having a radius of 5669.58 feet; thence southerly, along said westerly Right of Way line and along the arc of said curve, through a central angle of 10°47'22", an arc distance of 1067.65 feet, said arc being subtended by a chord, having a bearing and distance of South 05°19'39" East, 1066.07 feet; thence South 00°03'52" West, along said westerly Right of Way line, 3874.13 feet; thence North 89°56'09" West, 800.03 feet; thence South 00°03'55" West, 84.69 feet; thence South 69°20'56" West, 108.33 feet; thence North 73°50'15" West, 159.52 feet; thence North 24°39'11" West,

261.88 feet; thence North 23°00'36" East, 199.55 feet; thence North 89°55'03" West, 98.56 feet; thence North 22°31'09" West, 239.73 feet; thence North 42°51'10" East, 96.82 feet; thence North 17°35'17" East, 145.09 feet; thence North 15°46'35" West, 145.19 feet; thence North 50°14'42" West, 215.42 feet; thence North 56°00'00" West, 186.67 feet; thence North 44°39'17" West, 150.98 feet; thence North 35°43'36" East, 145.56 feet; thence North 72°58'07" East, 183.46 feet; thence North 68°39'43" East, 203.04 feet; thence North 69°04'40" East, 90.13 feet; thence South 62°21'12" East, 122.54 feet; thence South 27°03'04" East, 117.08 feet; thence South 47°42'18" East, 76.36 feet; thence South 39°08'20" East, 77.30 feet; thence South 03°58'03" West, 235.18 feet; thence South 05°44'46" East, 136.26 feet; thence South 44°15'49" East, 141.20 feet; thence North 69°44'58" East, 220.88 feet; thence North 05°12'00" West, 109.37 feet; thence North 39°25'10" West, 152.51 feet; thence North 57°38'04" West, 180.82 feet; thence North 02°34'46" West, 84.46 feet; thence North 39°30'32" East, 169.99 feet; thence North 39°27'22" East, 227.04 feet; thence North 01°00'54" East, 259.15 feet; thence North 72°45'41" West, 136.84 feet; thence South 89°22'58" West, 179.23 feet; thence North 14°40'31" East, 266.69 feet; thence North 14°40'31" East, 49.71 feet; thence North 00°11'00" East, 423.20 feet; thence North 25°23'00" West, 307.30 feet; thence North 42°58'36" West, 471.61 feet; thence North 53°30'38" West, 338.77 feet; thence North 43°44'50" West, 597.96 feet; thence North 33°12'36" West, 377.31 feet; thence North 49°59'47" East, 60.96 feet; thence North 43°00'30" East, 208.16 feet; thence North 16°39'09" West, 203.24 feet; thence North 05°46'47" East, 235.40 feet; thence North 21°12'33" East, 98.95 feet; thence South 53°34'47" East, 92.77 feet; thence South 49°07'44" East, 101.11 feet; thence South 68°30'45" East, 165.88 feet; thence North 38°02'07" East, 105.42 feet; thence North 74°08'39" East, 162.90 feet; thence North 07°54'08" East, 69.63 feet; thence North 34°39'21" East, 99.80 feet; thence North 08°13'06" West, 63.36 feet; thence North 79°37'11" West, 105.33 feet; thence North 89°40'46" West, 113.68 feet; thence North 32°16'39" West, 92.96 feet; thence North 71°48'00" East, 126.49 feet; thence North 45°40'30" East, 126.58 feet; thence North 21°26'38" East, 135.60 feet; thence North 37°20'25" East, 159.16 feet; thence North 10°55'55" East, 84.29 feet; thence North 51°13'09" West, 39.71 feet; thence South 54°18'19" West, 22.63 feet; thence North 81°51'16" West, 60.99 feet; thence South 72°55'59" West, 65.32 feet; thence North 81°30'54" West, 102.30 feet; thence South 83°31'14" West, 75.66 feet; thence South 74°59'24" West, 76.40 feet; thence North 88°23'25" West, 118.19 feet; thence South 73°13'40" West, 89.87 feet; thence South 43°47'13" West, 61.03 feet; thence South 39°26'55" West, 77.19 feet; thence South 14°09'40" West, 87.66 feet; thence South 12°31'53" West, 77.86 feet; thence South 23°34'50" West, 49.14 feet; thence North 79°39'42" West, 99.20 feet; thence North 89°02'34" West, 87.18 feet; thence South 19°22'18" West, 70.92 feet; thence North 53°47'57" West, 65.36 feet; thence South 69°13'45" West, 62.66 feet; thence South 30°30'51" East, 67.21 feet; thence South 59°39'18" East, 106.36 feet; thence South 76°32'10" East, 66.94 feet; thence North 43°54'33" East, 27.61 feet; thence South 59°00'07" East, 75.03 feet; thence South 58°05'46" West, 64.61 feet; thence North 81°35'13" West, 75.13 feet; thence South 04°18'25" East, 76.79 feet; thence South 16°13'07" East, 54.80 feet; thence South 52°16'06" East, 106.51 feet; thence South 06°03'18" East, 64.46 feet; thence South 03°47'54" East, 103.44 feet; thence South 07°52'10" West, 93.72 feet; thence South 09°37'43" West,

56.07 feet; thence South 32°11'16" West, 89.85 feet; thence South 34°23'59" West, 100.29 feet; thence South 46°13'58" West, 86.85 feet; thence South 16°44'53" West, 115.76 feet; thence South 00°57'21" East, 118.45 feet; thence South 03°54'10" West, 113.33 feet; thence South 13°08'08" East, 94.14 feet; thence South 01°28'55" East, 27.88 feet; thence South 15°33'29" East, 189.36 feet; thence South 14°10'29" East, 88.89 feet; thence South 43°48'28" West, 97.08 feet; thence South 37°58'53" West, 96.95 feet; thence South 00°25'08" East, 124.06 feet; thence South 07°32'56" West, 90.83 feet; thence South 23°13'12" West, 81.20 feet; thence South 16°47'35" West, 90.30 feet; thence South 06°23'40" West, 122.95 feet; thence South 04°05'24" East, 105.40 feet; thence South 45°44'19" West, 102.36 feet; thence South 11°13'55" East, 113.06 feet; thence South 04°11'02" West, 95.16 feet; thence South 23°50'36" West, 107.03 feet; thence South 00°03'45" East, 117.58 feet; thence South 21°11'50" West, 108.93 feet; thence South 40°02'36" West, 95.28 feet; thence South 31°12'58" West, 303.25 feet; thence South 45°08'12" West, 215.68 feet; thence South 45°08'11" West, 18.52 feet; thence South 23°22'12" West, 15.03 feet; thence South 20°41'13" East, 58.87 feet; thence South 36°57'05" East, 131.09 feet; thence South 73°36'20" East, 147.98 feet; thence North 75°14'13" East, 177.00 feet; thence North 88°38'53" East, 326.04 feet; thence South 62°25'00" East, 388.17 feet; thence South 58°13'31" East, 152.06 feet; thence South 05°44'01" West, 196.73 feet; thence South 26°22'39" West, 148.60 feet; thence South 39°05'39" West, 169.12 feet; thence South 07°14'36" West, 122.41 feet; thence South 16°31'46" West, 56.94 feet; thence South 20°44'13" East, 174.14 feet; thence South 57°49'59" East, 152.50 feet; thence North 82°47'21" East, 137.97 feet; thence North 83°23'00" East, 132.21 feet; thence North 67°13'43" East, 188.08 feet; thence South 19°18'21" East, 249.38 feet; thence North 89°55'05" West, 12.03 feet; thence South 03°21'35" West, 134.70 feet; thence South 80°14'17" West, 144.49 feet; thence South 44°26'33" West, 186.85 feet; thence South 21°05'08" West, 176.70 feet; thence South 04°57'48" West, 120.68 feet; thence South 58°47'40" East, 340.66 feet; thence North 57°45'47" East, 119.68 feet; thence North 74°38'21" East, 147.39 feet; thence South 63°03'59" East, 201.33 feet; thence South 34°35'13" East, 126.49 feet; thence South 89°40'51" East, 149.23 feet; thence South 06°37'10" West, 280.26 feet; thence South 59°28'07" East, 118.25 feet; thence North 21°18'46" East, 222.07 feet; thence North 56°24'31" East, 256.84 feet; thence North 82°55'55" East, 213.50 feet; thence North 72°18'00" East, 83.62 feet to a point on said westerly Right of Way line of State Road No. 121; thence South 00°03'52" West, along said westerly Right of Way line, 677.28 feet to a point lying 50.00 feet northerly of (measured perpendicular) the North line of the Yelvington Property as described in Official Records Book 2679, page 1316 of said Public Records; thence South 88°54'31" West, parallel with and 50.00 feet northerly of said North line of the Yelvington Property, 430.75 feet; thence South 89°25'18" West, parallel with and 50.00 feet northerly of said North line of the Yelvington Property, 3409.80 feet to a point on the northwesterly line of said 50 foot wide Florida Gas Transmission Easement as described in Official Records Book 48, page 205 of said Public Records; thence North 44°03'37" East, along said northwesterly line of the Florida Gas Transmission Easement, 258.98 feet; thence North 03°23'37" East, along the westerly line of said Florida Gas Transmission Easement, 84.27 feet; thence South 84°01'07" West, 13.24 feet; thence North 76°49'52" West, 93.88 feet; thence North 42°41'57" West, 62.10 feet; thence North 27°43'29" West, 52.51 feet;

thence North 33°16'59" West, 64.15 feet; thence North 37°17'44" West, 58.93 feet; thence North 39°07'09" West, 99.69 feet; thence North 43°06'33" West, 89.33 feet; thence North 24°51'56" West, 72.67 feet; thence North 27°58'05" West, 70.19 feet; thence North 48°15'31" West, 58.62 feet; thence North 59°59'37" West, 115.42 feet; thence North 62°14'50" West, 111.51 feet; thence North 64°03'17" West, 101.69 feet; thence North 71°56'47" West, 124.52 feet; thence North 78°09'21" West, 148.71 feet; thence North 67°11'31" West, 97.68 feet; thence North 49°01'19" West, 10.78 feet; thence South 67°29'05" West, 18.88 feet; thence South 67°29'05" West, 54.85 feet; thence South 28°48'44" West, 118.29 feet; thence South 09°24'52" East, 57.81 feet; thence South 30°16'02" East, 107.32 feet; thence South 09°01'53" East, 168.36 feet; thence South 00°19'37" East, 64.56 feet; thence South 00°19'36" East, 35.80 feet to a point on the northeasterly Right of Way line of a 50 foot wide strip of City of Gainesville land as described in Official Records Book 634, page 164 of said Public Records; thence North 46°30'35" West, along said northeasterly Right of Way line, 1302.18 feet to a 4" square concrete monument and cap stamped "PRM 3456" on the West boundary of Section 12, Township 9 South, Range 19 East; thence North 00°28'44" West, along the West boundary of said Section 12, a distance of 16.74 feet; thence North 65°12'51" East, 117.73 feet; thence North 85°59'53" East, 69.42 feet; thence South 62°51'58" East, 18.58 feet; thence South 23°01'51" East, 65.53 feet; thence South 27°17'52" East, 83.46 feet; thence South 09°46'50" East, 108.99 feet; thence South 81°17'08" East, 57.05 feet; thence North 50°23'52" East, 67.28 feet; thence North 69°31'15" East, 59.81 feet; thence North 78°35'15" East, 69.17 feet; thence North 31°04'46" East, 90.89 feet; thence North 12°04'37" East, 64.65 feet; thence North 72°07'13" East, 45.71 feet; thence South 46°20'57" East, 46.39 feet; thence South 71°14'56" East, 65.29 feet; thence South 14°46'00" West, 59.29 feet; thence South 22°48'06" East, 39.85 feet; thence South 75°47'54" East, 51.58 feet; thence North 56°21'24" East, 55.09 feet; thence North 11°52'08" West, 44.86 feet; thence North 17°56'34" East, 113.14 feet; thence North 78°05'04" East, 49.28 feet; thence South 66°24'03" East, 99.38 feet; thence South 46°14'26" East, 42.45 feet; thence South 15°57'29" West, 57.44 feet; thence South 60°29'46" West, 104.90 feet; thence South 70°04'57" East, 49.30 feet; thence South 70°04'57" East, 58.01 feet; thence North 49°56'05" East, 21.84 feet; thence North 72°34'16" East, 61.50 feet; thence North 86°02'04" East, 86.68 feet; thence North 76°28'37" East, 46.89 feet; thence North 46°52'36" East, 34.63 feet; thence North 85°17'48" East, 38.44 feet; thence North 83°50'14" East, 0.41 feet; thence North 82°18'12" East, 0.22 feet; thence North 57°01'08" East, 0.06 feet; thence North 54°28'11" East, 0.27 feet; thence North 53°41'31" East, 83.09 feet; thence North 60°33'30" East, 105.05 feet; thence North 59°29'16" East, 0.41 feet; thence North 57°29'13" East, 0.04 feet; thence North 40°20'43" East, 0.03 feet; thence North 36°07'58" East, 0.34 feet; thence North 35°18'11" East, 39.15 feet; thence North 34°42'40" East, 0.23 feet; thence North 31°00'19" East, 0.02 feet; thence North 17°24'10" East, 0.06 feet; thence North 11°50'10" East, 0.43 feet; thence North 10°43'46" East, 78.01 feet; thence North 09°32'45" East, 0.44 feet; thence North 07°53'23" East, 0.03 feet; thence North 05°46'38" East, 0.07 feet; thence North 03°39'08" East, 0.01 feet; thence North 07°22'43" West, 0.46 feet; thence North 08°32'21" West, 90.50 feet; thence North 32°14'47" East, 30.69 feet; thence North 23°09'32" East, 66.91 feet; thence North 23°54'24" East, 94.92 feet; thence North

30°01'28" East, 100.17 feet; thence North 27°53'15" East, 101.66 feet; thence North 22°54'50" East, 87.95 feet; thence North 10°14'06" East, 70.09 feet; thence North 15°50'58" West, 45.92 feet; thence North 36°57'23" West, 61.70 feet; thence North 35°15'35" West, 92.97 feet; thence North 31°18'52" West, 100.08 feet; thence North 26°22'07" West, 70.95 feet; thence North 07°11'18" East, 14.92 feet; thence North 01°04'20" East, 0.04 feet; thence North 38°49'12" West, 10.37 feet; thence North 14°48'32" West, 42.69 feet; thence North 01°18'04" East, 72.27 feet; thence North 24°15'28" East, 70.71 feet; thence North 33°19'17" East, 96.20 feet; thence North 28°49'20" East, 76.02 feet; thence North 06°58'27" East, 27.35 feet; thence North 25°19'11" West, 21.32 feet; thence North 14°12'30" East, 51.51 feet; thence North 19°30'05" East, 89.85 feet; thence North 18°35'22" East, 0.39 feet; thence North 80°11'59" West, 0.47 feet; thence North 81°18'12" West, 183.77 feet; thence North 78°04'05" West, 101.38 feet; thence North 79°04'59" West, 0.44 feet; thence South 51°52'12" West, 0.11 feet; thence South 46°06'20" West, 0.38 feet; thence South 44°56'56" West, 145.37 feet; thence South 43°33'50" West, 0.52 feet; thence South 42°29'26" West, 0.02 feet; thence South 39°27'17" West, 0.01 feet; thence South 38°10'13" West, 0.05 feet; thence South 08°09'06" West, 0.08 feet; thence South 04°02'29" West, 0.37 feet; thence South 03°01'04" West, 111.54 feet; thence South 04°14'14" West, 118.63 feet; thence South 03°04'13" West, 0.32 feet; thence South 01°01'37" West, 0.16 feet; thence South 00°27'50" East, 0.02 feet; thence South 31°49'24" East, 0.08 feet; thence South 34°24'41" East, 0.25 feet; thence South 35°12'26" East, 63.31 feet; thence South 20°27'24" West, 45.82 feet; thence South 19°44'16" West, 0.17 feet; thence South 15°22'13" West, 0.14 feet; thence South 36°20'22" East, 18.03 feet; thence South 01°49'54" West, 103.51 feet; thence South 67°42'15" West, 78.49 feet; thence North 47°11'47" West, 159.38 feet; thence North 47°07'52" West, 161.37 feet; thence North 62°40'12" West, 86.63 feet; thence North 87°59'24" West, 67.72 feet; thence South 73°03'05" West, 81.45 feet; thence South 71°00'41" West, 98.07 feet; thence South 82°03'26" West, 38.57 feet; thence North 47°33'56" West, 32.44 feet; thence North 48°34'30" West, 0.36 feet; thence North 49°55'59" West, 0.13 feet; thence North 53°31'42" West, 0.16 feet; thence North 53°57'31" West, 73.32 feet; thence North 54°53'30" West, 0.38 feet; thence North 58°56'45" West, 0.01 feet; thence North 60°34'21" West, 0.01 feet; thence North 88°26'02" West, 0.10 feet; thence North 90°00'00" West, 0.47 feet; thence South 88°41'36" West, 72.76 feet; thence South 88°01'22" West, 0.44 feet; thence South 87°39'41" West, 56.67 feet; thence South 86°25'57" West, 0.48 feet; thence South 84°41'52" West, 0.04 feet; thence South 74°58'22" West, 0.02 feet; thence South 41°44'09" West, 0.07 feet; thence South 39°32'30" West, 0.36 feet; thence South 38°36'39" West, 32.68 feet; thence North 78°11'18" West, 103.19 feet; thence South 86°28'46" West, 72.05 feet; thence South 83°55'07" West, 115.58 feet; thence South 78°01'58" West, 82.97 feet to the Point of Beginning.

Containing 613.519 Acres (26,724,900 Square Feet), more or less.

EXHIBIT OF GAINESVILLE SR 121 PD LANDS

A PORTION OF FRACTIONAL SECTIONS 1, LYING INSIDE AND OUTSIDE OF THE AREONDO GRANT AND A PORTION OF SECTION 12, TOWNSHIP 9 SOUTH, RANGE 19 EAST, AND A PORTION OF FRACTIONAL SECTIONS 6, LYING INSIDE AND OUTSIDE OF THE AREONDO GRANT AND A PORTION OF SECTION 7, TOWNSHIP 9 SOUTH, RANGE 20 EAST AND A PORTION OF SECTION 36, TOWNSHIP 8 SOUTH, RANGE 19 EAST AND A PORTION OF SECTION 31, TOWNSHIP 8 SOUTH, RANGE 20 EAST ALACHUA COUNTY, FLORIDA

WETTERHAUSER NR COMPANY

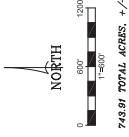

LEGEND OF SYMBOLS & ABBREVIATIONS

- NO. = NUMBER
- REC. = RECORDS BOOK
- PAGE = PAGE
- PLAT = PLAT
- TR. = TRACT
- SECT. = SECTION
- BLK. = BLOCK
- CON. = CONCRETE MONUMENT (SIZE, E.G.)

V-1001

No.	Date	Comments

WETTERHAUSER NR COMPANY
 12000 WETTERHAUSER DRIVE
 SUITE 100
 GAINESVILLE, FLORIDA 32608
 TEL: 352-371-1111
 FAX: 352-371-1112
 www.wetterhauser.com

WETTERHAUSER NR COMPANY
 12000 WETTERHAUSER DRIVE
 SUITE 100
 GAINESVILLE, FLORIDA 32608
 TEL: 352-371-1111
 FAX: 352-371-1112
 www.wetterhauser.com

WETTERHAUSER NR COMPANY
 12000 WETTERHAUSER DRIVE
 SUITE 100
 GAINESVILLE, FLORIDA 32608
 TEL: 352-371-1111
 FAX: 352-371-1112
 www.wetterhauser.com

PRINTED AT: 20. 2017 - 11:48:08 - FPKW